



**Thank you for
attending the 8th
National Conference on
Access Management.**

TRB Access Management Committee
Kristine Williams, Chair

www.accessmanagement.info
(813) 974-9807 • kwilliams@cutr.usf.edu

8th National Conference on Access Management

"Sustainable
Solutions for
Transportation"

July 13-16, 2008 ♦ Baltimore, MD



TRB



SHA
State Highway
Administration



CONFERENCE PROGRAM



Welcome to Baltimore!

On behalf of the Access Management Committee and the Maryland State Highway Administration, it is our pleasure to welcome you to the 8th National Conference on Access Management here in Charm City. In addition to participating in all the conference program has to offer, please take some time to explore and enjoy downtown Baltimore. We are pleased to be holding this conference at the Renaissance Harborplace Hotel. Its prime Inner Harbor location, deluxe conference facilities and friendly staff make it the perfect place for such an event. We are also very excited about our off-site event this year, which will be held on Tuesday evening. Details on this event can be found below.

The theme of the Conference is *"Sustainable Solutions for Transportation"*. With fewer new arterial roadways being built, the need for effective systems management strategies is greater than ever before. Access management policies and tools are particularly attractive as they offer a variety of benefits to a broad range of stakeholders. By managing roadway access and maintaining the integrity of the functional classification system, government agencies can increase public safety, extend the life of major roadways, reduce traffic congestion, support alternative transportation modes and even improve the appearance and quality of the built environment.

Be sure to join us at the Welcome Reception on Sunday evening, from 5:30 to 7:30 PM in Baltimore Ballroom B on the 5th floor. This will be the perfect opportunity to network with other professionals in the Access Management arena as well as re-connect with old friends. Once again, welcome to Baltimore!

Vaughn Lewis
Conference Chair

TRAVEL INFORMATION



- ◆ Taxis are available outside the first floor (South Street) lobby of the hotel. Estimated taxi fare to Baltimore Washington Airport (BWI) is \$32.00 one way.
- ◆ The Airport Shuttle (www.gothearportshuttle.com) provides shared ride service between all area airports and downtown hotels. A group rate of \$16 one way to BWI or Amtrak/BWI is being offered for conference registrants.
- ◆ Super Shuttle (www.supershuttle.com) provides reserved and unreserved multi-stop shuttle service between all area airports and the downtown hotels. Current cost is \$13 one way to BWI.
- ◆ Boarding passes can be printed out at the kiosk in the main lobby of the hotel.

OFF SITE EVENT



Our conference team has planned an exciting event for Tuesday evening. After the sessions conclude for the day, charter buses will take us to Fort McHenry for a self-guided tour and inspirational film. It was the battle of Fort McHenry during the War of 1812 that inspired Francis Scott Key to write the words to what we know as the Star Spangled Banner, our national anthem. After the Fort, we will head over to the Baltimore Museum of Industry for dinner, networking, a fabulous Harbor view and a chance to view several museum exhibits - including one dedicated to the 100th year anniversary of the Maryland State Highway Administration. All conference registrants are invited to attend.

If you are attending the off site event, please meet at 4:15 at the South Street Lobby level of the hotel. Buses will begin leaving for Fort McHenry at 4:30.

See you at the **9th National
Conference
on Access
Management
2010**



IN NATCHEZ, MS

Jeff Altman, Chairperson

jaltman@mdot.state.ms.us • 601-359-7685



PARTNERS IN PROGRESS

Baltimore
Metropolitan
Council



Proud **Gold Sponsor**
of the 8th National Conference on Access Management



Merging Innovation and Excellence®

www.trafficgroup.com

We would like to thank all of the Sponsors for this 8th National Conference on Access Management

Transportation Research Board

Access Management (AHB70)
Geometric Design (AFB10)
Operational Effects of Geometrics (AHB65)

Maryland State Highway Administration

Federal Highway Administration

PLATINUM Sponsors

- RK&K
- McCormick Taylor

STUDENT POSTER Sponsors

- HDR, Inc

GOLD Sponsors

- Century Engineers
- The Traffic Group
- KCI
- URS

SILVER Sponsors





- Baltimore Metropolitan Council

Special Thanks to:

- Morgan State University
- Old Bay, Inc.



ENGINEERS ARCHITECTS PLANNERS

4 North Park Drive, Suite 300
Hunt Valley, Maryland 21030

410-785-7220
410-785-6818 fax
www.urscorp.com

Engineers | Planners | Scientists | Construction Managers



KCI
TECHNOLOGIES

www.kci.com
Employee-owned Since 1988





KCI has offices in the Northeast, Southeast, and Mid-Atlantic



Ron Giguere
(1947 - 2008)

With deep sadness, the TRB Access Management Committee mourns the loss earlier this year of long-time friend and partner Ron K. Giguere, Manager of the ITS Professional Capacity Building Program at the U.S. Department of Transportation. Ron's contri-bution to the industry and to this Committee was invaluable and he will be deeply missed.

Ron was the first Chair of the Access Management Committee and was instrumental in its founding. He spearheaded the development of the Access Management Manual and was always a determined advocate of access management principles. He was also a kind and thought-ful person who was always there to lend advice and support.

We will miss him.

Sunday July 13, 2008			
Registration: 12:30 PM – 4:30 PM			
Time	Baltimore A	Baltimore B	Homeland
1:00 – 2:30			Workshop 1 The Use and Abuse of Crash Data in Roadway Access Management; <i>Dave Plazak</i> <i>(Sign-up required)</i>
2:30 – 3:00	Afternoon Break		
3:00 – 5:00			Workshop 1 Continued
5:30 – 7:30		Welcome Reception	

Monday July 14, 2008			
Registration: 7:00 AM – 4:30 PM			
Time	Baltimore A	Baltimore B	Homeland
7:00 – 8:15	Continental Breakfast		
8:15 – 9:30	Opening Session <i>Vaughn Lewis, Presiding</i>		
9:30 – 10:00	Mid-Morning Break & Poster Session		
10:00 – 11:45	Impact Evaluations and Performance Measures <i>J. L. Gattis, Moderating</i>	State DOT AM Programs <i>Rick Laughlin, Moderating</i>	Workshop 2 Road Trip: An Interactive Workshop on Roadway Facility Management <i>Del Huntington</i> <i>(Sign-up required)</i>
11:45 – 1:00	Lunch		
1:00 – 2:45	Design and Traffic Engineering <i>Jerry Gluck, Moderating</i>	Guidelines, Policies and Standards <i>Tom Hiles, Moderating</i>	Workshop 3 Access Management Applications in Maryland - Urban, Suburban and Rural Examples <i>Shiva Shrestha</i>
2:45 – 3:15	Afternoon Break & Poster Session		
3:15 – 5:00	Business Impacts and Stakeholder Involvement <i>Stephen Ferranti, Moderating</i>	Progression and Circulation <i>Bob Jurasin, Moderating</i>	Workshop 4 An Interactive Workshop on Scoping an Effective Corridor Study <i>Chris Huffman</i>





81 Mosher Street
Baltimore, Maryland 21217
410-728-2900
1-800-787-3755
www.rkk.com

Office Locations:

Maryland
Delaware
Florida
North Carolina
Pennsylvania
Virginia
West Virginia
District of Columbia

"RK&K - Your Engineering Partner Since 1923"

- Transportation / Transit Systems
- Water / Wastewater Facilities
- Construction Management / Inspection
- Utility Systems
- Geotechnical Engineering
- Structural Engineering
- Land / Site Development
- Water Resources / Natural Environment
- Planning
- Hazardous Waste Assessment / Remediation
- Geographic Information Systems
- Computer Programming

Engineering ■ Environmental ■ Planning ■ Communications



"Your access to a successful product."

McCormick Taylor offers a diverse team of professional engineers, planners, scientists and landscape architects dedicated to improving transportation infrastructure while enhancing the environment we live in. Our mission is to integrate sound engineering principles with unique environmental concepts in every project we do to preserve, restore and enhance the cultural, natural and socio-economic environments.



509 South Exeter Street
4th Floor
Baltimore, MD 21202
(410) 662.7400
www.mccormicktaylor.com
11 Offices in MD, PA, NJ, DE, VA, & OH

Committee / Subcommittee Meeting Schedule

Tuesday July 15, 2008		
Access Management Subcommittee: Outreach	Federal Hill	7:00 AM – 8:00 AM

Wednesday July 16, 2008		
Access Management Subcommittee: Research	Watertable A	7:00 AM – 8:00 AM
Access Management Subcommittee: Manual	Federal Hill	7:00 AM – 8:00 AM
Lunch – Committee Members Only <ul style="list-style-type: none"> Access Management (AHB70) Geometric Design (AFB10) Operational Effects of Geometrics (AHB65) 	Watertable B/C	12:00 PM – 1:00 PM
Access Management Committee	Federal Hill	1:00 PM – 4:00 PM
Geometric Design Subcommittee: Technical	Watertable A	1:00 PM – 2:15 PM
Operational Effects Subcommittee: Freeway	Watertable B	2:15 PM – 3:30 PM
Operational Effects Subcommittee: Performance Based Analysis and Speed Effects	Watertable B	3:30 PM – 4:45 PM
Geometric Design Subcommittee: Business	Watertable A	3:30 PM – 4:45 PM
Joint Subcommittees: Geometric Design’s Technical and Operational Effects’ Performance-Based Analysis and Speed Effects	Watertable A	4:45 PM – 6:00 PM
Intersections Joint Subcommittee	Watertable A	7:00 PM – 8:30 PM
International Symposium Joint Steering Committee	Watertable B	8:30 PM – 10:00 PM

Thursday July 17, 2008		
Geometric Design Joint Subcommittees: Technical and Research	Federal Hill	8:00 AM – 9:00 AM
Geometric Design – Technical Subgroups: Freeways/Interchanges and Highways	Federal Hill	9:00 AM – 10:15 AM
Geometric Design – Technical Subgroups: Streets/Intersections and Methodology	Gibson	10:15 AM – 11:30 AM
Geometric Design – Technical Subgroups: Chairs Follow-up Meeting	Gibson	11:30 AM – 12:00 PM
Operational Effects of Geometric Design Committee	Federal Hill	1:00 PM – 3:00 PM
Geometric Design Committee	Gibson	1:00 PM – 3:00 PM
Joint Full Committees	Federal Hill	3:00 PM – 5:00 PM

Tuesday July 15, 2008			
Registration: 7:30 AM – 1:00 PM			
Time	Baltimore A	Baltimore B	Homeland
7:00 – 8:00	Continental Breakfast		
8:00 – 9:45	Sponsoring Committee: Geometric Design (AFB10) <i>Larry Sutherland, Moderating</i>	Access Permitting Processes <i>Jeff Altman, Moderating</i>	Workshop 5 Effective Access Management Regulations and Procedures <i>Kristine Williams and Vergil Stover</i>
9:45 – 10:15	Mid-Morning Break & Poster Session		
10:15 – 12:00	Workshop 6 Getting People Involved Productively <i>Judy Meyer</i>	Plan Development and Implementation <i>Christina Hopes, Moderating</i>	Workshop 7 Non-Traditional Intersection / Interchange Informational Report (NTIIR) <i>Ramanujan Jagannathan</i>
12:00 – 1:15	Lunch		
1:15 – 3:30	Workshop 6 Continued	Workshop 8 Road Trip: An Interactive Workshop on Roadway Facility Management <i>Del Huntington (Sign-up required)</i>	Workshop 7 Continued
4:15	Offsite Dinner Event Ft. McHenry <i>(Sign-up required)</i>		

Wednesday July 16, 2008			
Time	Baltimore A	Baltimore B	Homeland
7:00 – 8:00	Continental Breakfast		
8:00 – 10:00	Sponsoring Committee: Operational Effects of Geometrics (AHB65) <i>Brandon Nevers, Moderating</i>	Land Use and Access Management <i>Donna Lewis, Moderating</i>	Workshop 9 Successful Public Involvement: Engaging Stakeholders <i>Bill Eisele and Bill Frawley</i>
10:00 – 10:30	Mid-Morning Break & Poster Session		
10:30 – 12:00	Closing Session		

HOTEL FLOOR PLAN

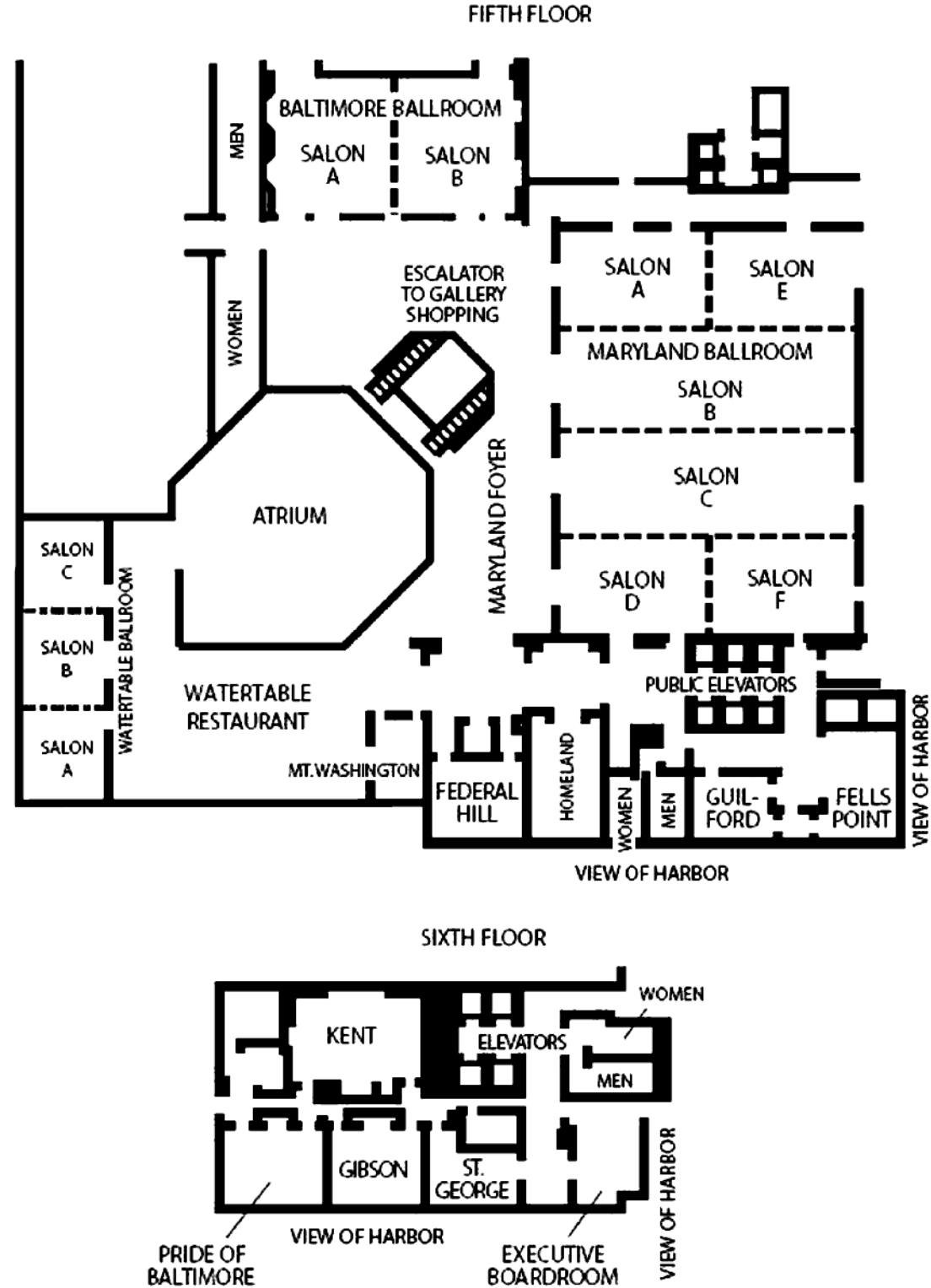

Poster Presentations

Throughout the course of the conference, there will be poster presentations available for viewing in the Baltimore Ballroom foyer area. At various times, the authors will be available to answer questions and discuss the material presented. In addition to the posters listed below, be on the lookout for student posters.

Poster Title	Author	Organization
Access Management in Pictures: The Good, the Bad, and the Ugly	William Eisele	Texas Transportation Institute
Outreach Materials Developed for TxDOT	William E. Frawley	Texas Transportation Institute
Geometric Design of Driveways Update	J. L. Gattis	University of Arkansas
High Capacity Multi-Lane Roundabout Design and Implementation	Mark T. Johnson	MTJ Engineering

Be on the lookout for Student posters!

This year's conference will include a first-ever student poster competition, sponsored by HDR, Inc. In addition to exposing young professionals to access management as a tool in transportation planning and design, the competition allows students to develop their professional skills by interacting with experienced leaders on the forefront of this topic.

Student posters will be on display in the foyer outside the Baltimore Ballrooms throughout the conference. A cash prize will be awarded to the winner, who will be announced during the Closing Session on Wednesday morning. Good luck to all the participants!



Student Posters

Poster Title	Author	School
Access Management in Optimizing Hurricane Evacuation Operations	Abbas Mohasel Afshar	University of Maryland
Rating the Sustainability of Transportation Investments: Corridors as a Case Study	Michelle Oswald	University of Delaware
A Sustainable Access Management Investigation Using Micro Simulation for US 69	Eric J. Fitzsimmons	Iowa State University
Comparison of Various Methods of Defining Access Density and Proposing a Weighted Methodology	Meeta Saxena	University of South Florida
Using Conflict Points to Measure the Performance of an Access Management Program	John Connelly	University of Virginia

Tuesday, July 15

1:15 – 3:30 Baltimore A	WORKSHOP 6 CONTINUED
1:15 – 3:30 Baltimore B	WORKSHOP 8 Road Trip : An Interactive Workshop on Roadway Facility Management; Del Huntington, Kittelson & Associates; (Sign-up required)
1:15 – 3:30 Homeland	WORKSHOP 7 CONTINUED
4:15	OFFSITE DINNER EVENT South Street Exit, Lobby Level, Buses begin leaving for Fort McHenry at 4:30 Dinner at Baltimore Museum of Industry at 6:30

Wednesday, July 16

7:00 – 8:00	CONTINENTAL BREAKFAST
	CONCURRENT SESSIONS
8:00 –10:00 Baltimore A	Sponsoring Committee Podium Session (AHB65); Brandon Nevers, Kittelson & Associates, Moderator National Agenda for Intersection Safety; Rich Coakley, CH2M Hill FHWA Technical Guide on Access Management; Del Huntington, Kittelson & Associates Data Needs for Intersection Safety; Ed Stollof, ITE Issues Related to Geometric Design of Intersections; Vergil Stover, Texas A & M University
8:00 – 10:00 Baltimore B	Land Use and Access Management; Donna Lewis, Mercer County, NJ, Moderator Linking Land Use and Transportation Decision Making in New York; Steve Munson, NYDOT Assessing Development Impacts from Infrastructure Alternatives that vary from Local Land Use Plans; Michele Jones, McCormick Taylor Tying Transportation Improvements, Future Land Use, Access Management, and Zoning Regulations Together for Successful Implementation; Rob Nesbitt, LSL Planning, Inc.
8:00 – 10:00 Homeland	WORKSHOP 9 Successful Public Involvement: Engaging Stakeholders; Bill Eisele and Bill Frawley, Texas Transportation Institute
10:00 – 10:30	MID MORNING BREAK & POSTER SESSION
10:30 – 12:00 Baltimore A and B	CLOSING SESSION Access Management Resources – An Orient-Invit-ation; Frank Broen, Teach America What Do You Do Now? An Interactive Discussion; Bill Frawley, Texas Transportation Institute; Frank Broen, Teach America Student Poster Competition Award; Thomas Hiles, HDR, Inc. Looking Ahead to 2010 – Natchez, Mississippi; Jeff Altman, Mississippi DOT

Sunday, July 13

12:30 – 4:30	REGISTRATION - INFORMATION
1:00 – 2:30 Homeland	WORKSHOP 1 The Use and Abuse of Crash Data in Roadway Access Management; Dave Plazak, Iowa State University (Sign-up required)
2:30 – 3:00	AFTERNOON BREAK
3:00 – 5:00 Homeland	WORKSHOP 1 CONTINUED
5:30 – 7:30 Baltimore B	WELCOME RECEPTION

Monday, July 14

7:00 – 4:30	REGISTRATION
7:00 – 8:15	CONTINENTAL BREAKFAST
8:15 – 9:30 Baltimore Ballroom A & B	OPENING SESSION Vaughn Lewis, Maryland State Highway Administration Welcome; John Porcari, Secretary, Maryland Department of Transportation FHWA Perspective on Access Management (Keynote); Regina McElroy, Director, Office of Transportation Management, Federal Highway Administration (Keynote) Access Management: Past, Present, and Future; Kristine Williams, Committee Chair, Center for Urban Transportation Research
9:30 – 10:00	MID MORNING BREAK AND POSTER SESSION
	CONCURRENT SESSIONS
10:00 – 11:45 Baltimore A	Impact Evaluations and Performance Measures; J.L. Gattis, University of Arkansas, Moderator Impacts of AM Management Case Study: Ward Drive, Hwy 60, Conway, AR; Minh Le, Metroplan Safety evaluation of access points near intersections and interchanges in NC; Reza Jafari, Chas H. Sells, Inc. Identification of Performance Measures to Evaluate Access Management Programs; John Connelly, VDOT Florida Site Impact Handbook; Gary Sokolow, Florida DOT
10:00 – 11:45 Baltimore B	State DOT AM Programs; Rick Laughlin, HDR, Inc., Moderator The Road to AM in Virginia; Paul Grasewicz, VDOT NJ Highway Access Code Reevaluation Study; James Lewis, NJDOT Prioritizing Access Management Implementation; Grant Schultz, Brigham Young University Developing Corridor Studies in NC; David Wasserman, NCDOT
10:00 – 11:45 Homeland	WORKSHOP 2 Road Trip: An Interactive Workshop on Roadway Facility Management; Del Huntington, Kittelson & Associates; (Sign-up required)
11:45 – 1:00	LUNCH
Monday schedule continues next page...	

Monday, July 14

CONCURRENT SESSIONS

1:00 – 2:45	Design and Traffic Engineering; Jerry Gluck, Urbitran Associates, Moderator
Baltimore A	<p>Warrants for Left-Turn Lanes at Unsignalized Access Connections; <i>Ida Van Schalkwyk, Arizona State University</i></p> <p>High Capacity Multi-Lane Roundabout Designs and Implementation; <i>Mark Johnson, MTJ Engineering LLC</i></p> <p>Geometric Design of Driveways Update; <i>J. L. Gattis, University of Arkansas</i></p> <p>Driveways, Parking, Bicycles, and Pedestrians: Balancing Safety and Efficiency; <i>Karen Dixon, Oregon State University,</i></p>
1:00 – 2:45	Guidelines, Policies and Standards; Tom Hiles, HDR, Inc., Moderator
Baltimore B	<p>Development of CARTS AM Standards using the TRB AM Manual; <i>Minh Le, Metroplan Franklin County, VA AM Guidebook; Andrew Boenau, Vanassee Hangen Brustlin, Inc.</i></p> <p>Guide for Evaluating and Updating Corridor management Policies and Procedures; <i>Kristine Williams, USF</i></p> <p>Implementing MoDOT’s Access Management Guidelines along Route 763; <i>Michael Trueblood, HDR</i></p>
1:00 – 2:45	WORKSHOP 3
Homeland	Access Management Applications in Maryland – Urban, Suburban and Rural Examples; <i>Shiva Shrestha, MD State Highway Administration</i>
2:45 – 3:15	AFTERNOON BREAK & POSTER SESSION

CONCURRENT SESSIONS

3:15 – 5:00	Business Impacts and Stakeholder Involvement; Stephen Ferranti, SRF Associates, Moderator
Baltimore A	<p>Comprehensive Public Involvement in Access Management Projects; <i>Bradley K. Strader, LSL Planning, Inc.</i></p> <p>MN 10 Anoka County Business Stakeholder Involvement Process; <i>David Plazak, Iowa State University</i></p> <p>Outreach Materials Developed for TXDOT; <i>Bill Frawley, Texas Transportation Institute</i></p> <p>Assessing Indirect Economic Impacts based on Access Improvements; <i>Bob Maimone, McCormick, Taylor & Associates</i></p>
3:15 – 5:00	Progression and Circulation; Bob Jurasin, CH2M Hill, Moderator
Baltimore B	<p>Driveways and Roundabouts; <i>Ken Sides, City of Clearwater</i></p> <p>The Impact of Access to Transit Roads in Built-up Areas on Road Safety and Traffic Progression; <i>Marian Tracz, Cracow University of Technology</i></p> <p>An Update on Superstreet Implementation and Research; <i>Joe Hummer, NC State University</i></p> <p>Improving Safety and Operations by Limiting Access on VA 28; <i>Randy Dittberner, VDOT</i></p>
3:15 – 5:00	WORKSHOP 4
Homeland	An Interactive Workshop on Scoping an Effective Corridor Study; <i>Chris Huffman, Kansas DOT</i>

Tuesday, July 15

REGISTRATION

CONTINENTAL BREAKFAST

CONCURRENT SESSIONS

8:00 – 9:45	Sponsoring Committee: Geometric Design (AFB10); Larry Sutherland, Transystems Inc, Moderator
Baltimore A	<p>Virginia DOT’s New Access Management Manual; <i>Richard C. Worssam, VDOT</i></p> <p>Incorporating Geometric Design Into Access Permit Regulations; <i>Phillip Demosthenes, Parametric Consulting</i></p> <p>Operational and Safety Effects of Right-Turn Deceleration Lanes on Urban and Suburban Arterials; <i>Ingrid Potts, Midwest Research Institute</i></p> <p>Designing and Managing Interchanges in Collaboration with the Public: An Interchange Area Management Plan Case Study; <i>Marc Butorac, Kittelson & Associates</i></p>
8:00 – 9:45	Access Permitting Processes; Jeff Altman, Mississippi DOT, Moderator
Baltimore B	<p>KDOT’s Electronic Highway Access Permit System (HAPS); <i>Luann Roth, Kansas DOT</i></p> <p>Turn Lanes, Medians & Right of Way – Getting What You Ask For; Development of MnDOT’s Permitting Policy; <i>Brian Gage, MnDOT</i></p> <p>Oregon DOT Dispute Resolution Process; <i>Ann Zeltman, Oregon DOT</i></p>
8:00 – 9:45	WORKSHOP 5
Homeland	Effective Access Management Regulations and Procedures; <i>Kristine Williams (USF) and Virgil Stover, Texas A & M University</i>
9:45 – 10:15	MID MORNING BREAK & POSTER SESSION

CONCURRENT SESSIONS

10:15 – 12:00	WORKSHOP 6
Baltimore A	Getting People Involved Productively; <i>Judy Meyer, Public Information Associates</i>
10:15 – 12:00	Plan Development and Implementation; Christina Hopes, Maricopa Association of Governments, Moderator
Baltimore B	<p>NW 86th Street Transportation Plan: Complexities of Managing Access with Plans, Land Redevelopment, and Street Redesign; <i>Jamie Tunnell, Snyder & Associates, Inc.</i></p> <p>US 1 Howard County Access Improvement Strategy; <i>Yolanda Takesion, Kittleson & Associates, Inc.</i></p> <p>Interim Access Management Plan for a Two-Lane Highway Prior to Dualization; <i>Karen Kahl, Rummel, Klepper and Kahl, LLP</i></p> <p>Rural Access Management – “Innovative Approaches in Expressway to Freeway Conversion”; <i>Darren Fortney, Short Elliot Hendrickson Inc.</i></p>
10:15 – 12:00	WORKSHOP 7
Homeland	Joint Sponsoring Committees Workshop (AFB10 / AHB65); Non-Traditional Intersection / Interchange Informational Report (NTIIR); <i>Ramanujan Jagannathan, VHB</i>
12:00 – 1:15	LUNCH IN BALTIMORE FOYER

Tuesday schedule continues next page...